

CORTE HORIZONTAL 1 (Ch1)
Esc. 1:25 - colas en m.

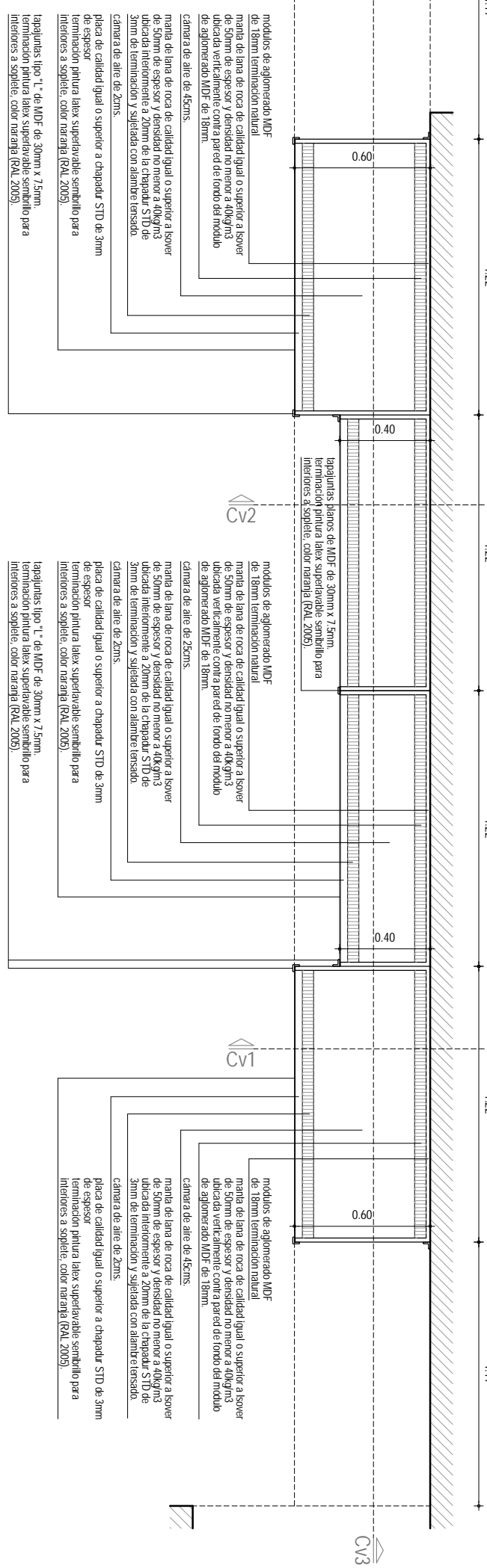

CORTE HORIZONTAL 2 (Ch2)
Esc. 1:25 - cotas en m.

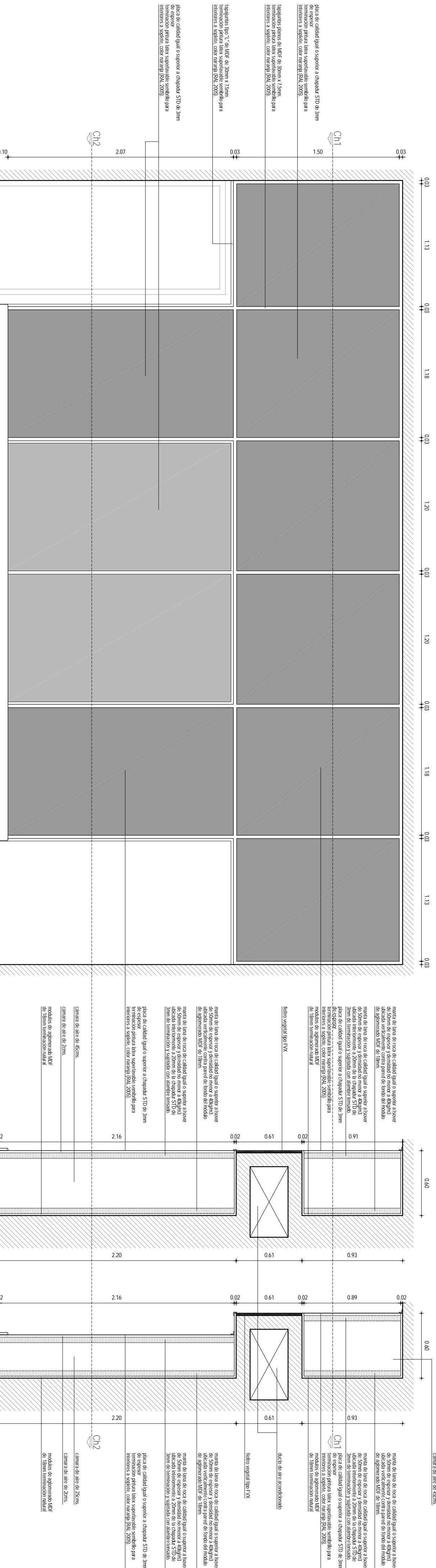

VISTA FRONTAL
Esc. 1:25 - cotas em m.

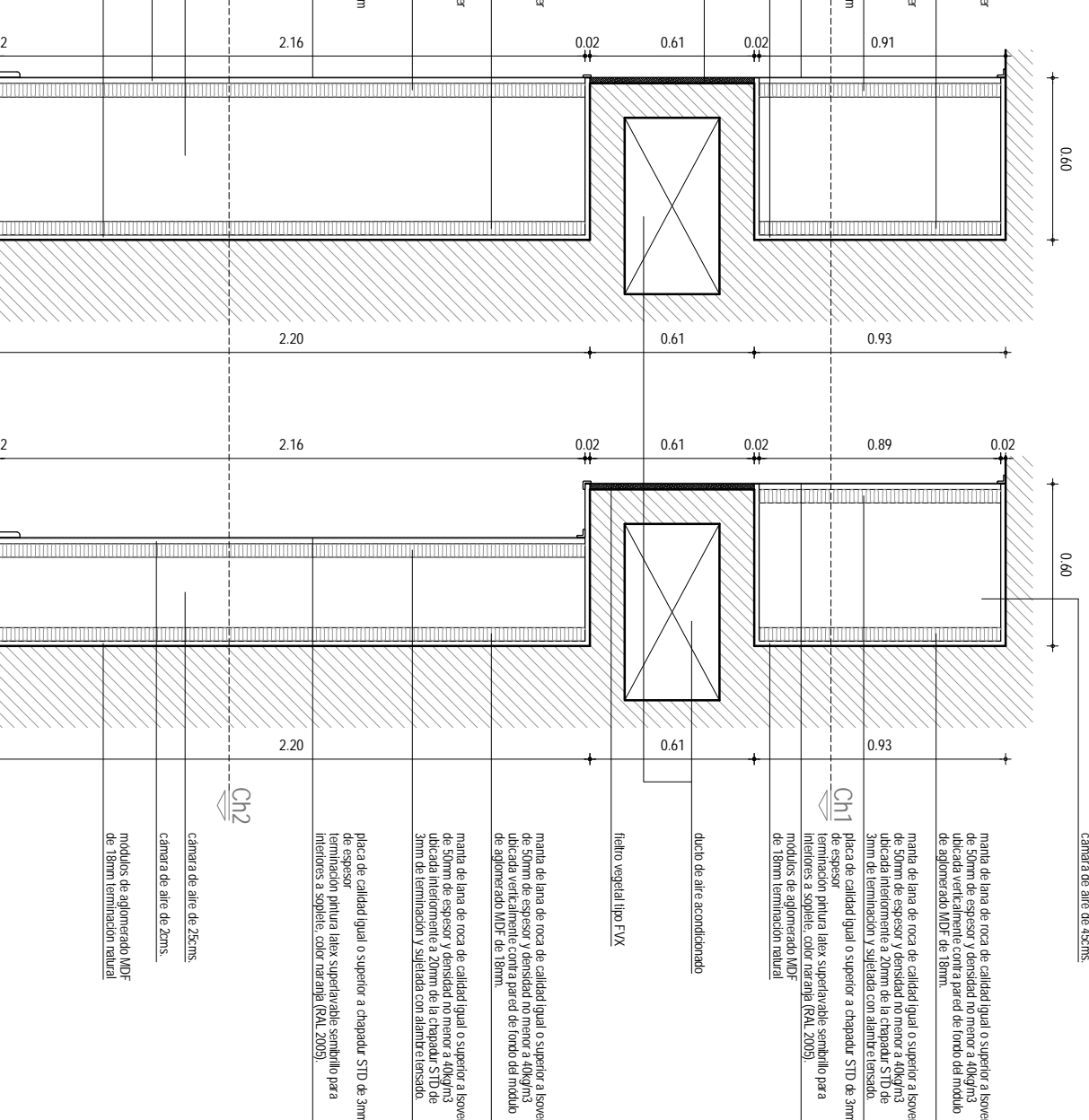

CORTE VERTICAL 1 (CV1)
Esc. 1:25 - cotas en m.

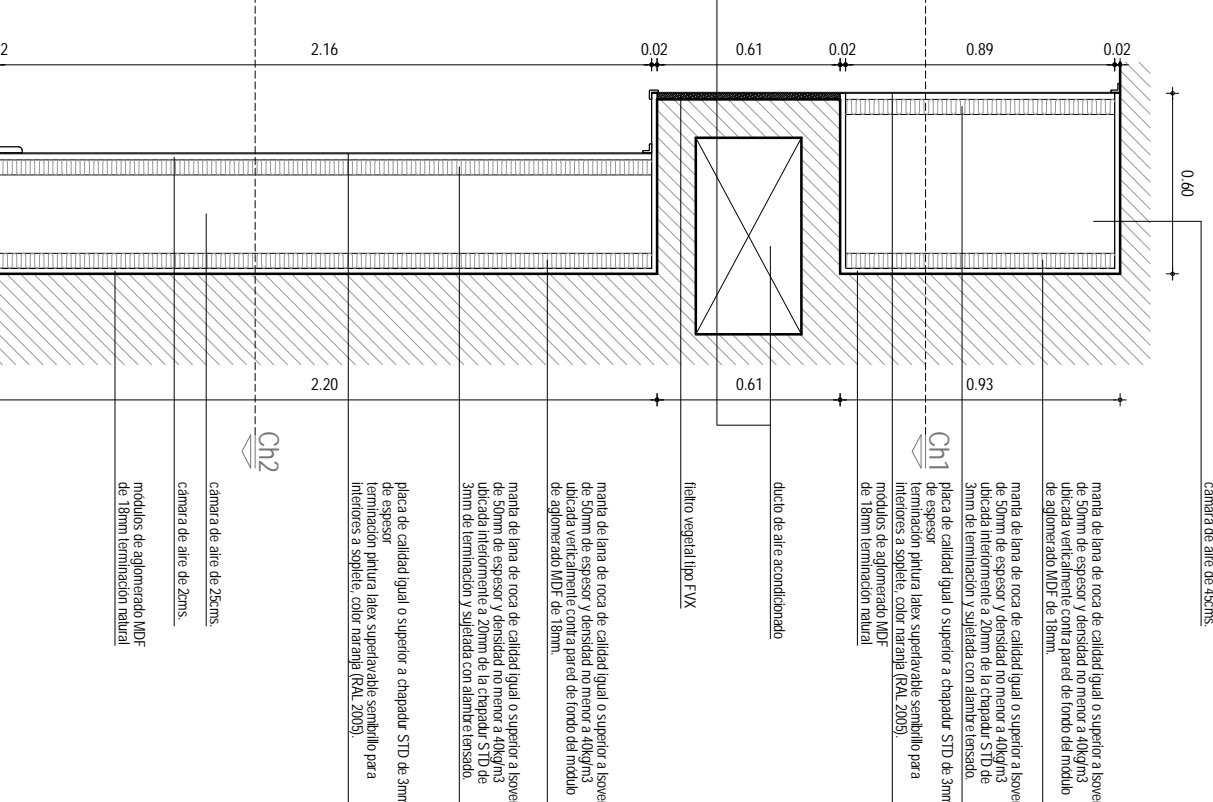

CORTE VERTICAL 2 (CV2)
Esc. 1:25 - cotas en m.

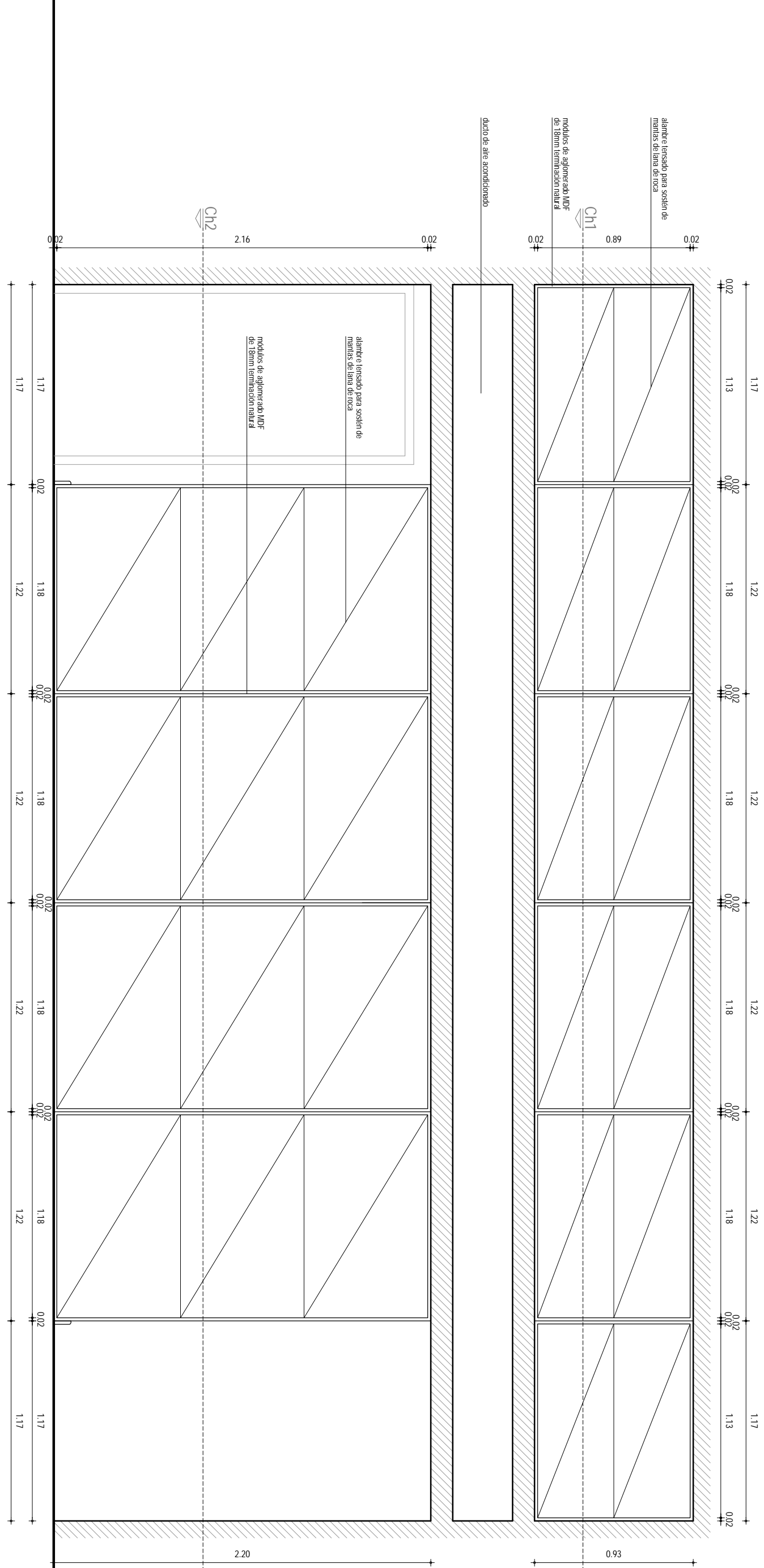

CORTE VERTICAL 3 (CV3)
Esc. 1:25 - cotas en m.